

I HEREBY CERTIFY THAT THIS PLAT WAS PREPARED FROM A FIELD SURVEY MADE UNDER MY DIRECT SUPERVISION. MONUMENTS WERE FOUND OR SET AS INDICATED. DIMENSIONS ARE EXPRESSED IN FEET AND DECIMAL PARTS THEREOF. BEARINGS REFER TO AN ASSUMED MERIDIAN AND ARE INTENDED TO INDICATE ANGLES ONLY. ALL OF WHICH ARE CORRECT TO THE BEST OF MY KNOWLEDGE AND BELIEF. THIS PLAT WAS PREPARED IN ACCORDANCE WITH THE PROVISIONS OF CHAPTER 4733-37 OF THE OHIO ADMINISTRATIVE CODE.

[Signature] 7-1-04
 RUDY E. SCHWARTZ, P.S. NO. 7193

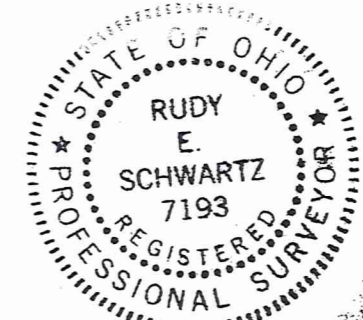

LEGEND

I. P.	Iron Pin
I.P.P.	Iron Pipe
Mon.	Monument
Fnd.	Found
D.	Deed
P.	Plat
R/Rec.	Record
M/Msd.	Measured
O/Obs.	Observed
C/Calc.	Calculated
U.	Used
Encr.	Encroachment
C.L.	Centerline
R.W.	Right-Of-Way

PLAT OF SURVEY AND LOT SPLIT FOR KEN ASHBA

Situated in the Township of Burton, County of Geauga and State of Ohio and known as being a part of Lot No. 32 and further being known as part of lands conveyed to Kenneth R. Ashba III and Lynn M. Ashba by deed recorded in Volume 1735, Page 3269 of Geauga County Deed Records and Kenneth R and Delores E. Ashba by deed recorded in Volume 1747, Page 2273 of Geauga County Deed Records.

PREPARED BY:
 SCHWARTZ LAND SURVEYING, INC.
 12121 KINSMAN ROAD
 NEWBURY, OHIO 44065
 (440)564-8174
 FAX:(440)564-8285

PREPARED FOR:
 KEN ASHBA
 FAIRMOUNT ROAD
 NEWBURY, OHIO 44065

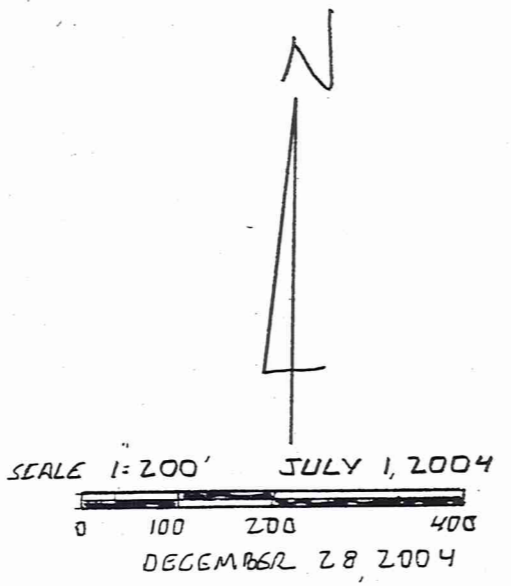

SURVEY PLAT & LEGAL DESCRIPTION
 APPROVED PER R.C. 315.251

PAK 12/30/04
 OFFICE OF THE
 GEAUGA COUNTY ENGINEER

LEGAL DESCRIPTION
OF A
0.1233 ACRE PARCEL
TO BE CONVEYED TO
KENNETH R. AND DELORES E. ASHBA

Situated in the Township of Burton, County of Geauga and State of Ohio and known as being a part of Lot No. 32 and further being known as part of a parcel of land conveyed to Kenneth R. Ashba III and Lynn M. Ashba by deed recorded in Volume 1735, Page 3269 of Geauga County Deed Records, further bounded and described as follows:

Beginning at a point in the centerline of Kinsman Road (S.R. 87), width varies, at its intersection with the centerline of Aquilla Road, 60 feet wide, as shown by Centerline Plat of Aquilla Road on file at the Geauga County Engineer's office;

Thence North 07°31'14" West along said centerline of Aquilla Road a distance of 756.52 feet to a monument box with a 1" iron pin found at an angle point therein;

Thence North 10°16'12" West continuing along said centerline of Aquilla Road a distance of 728.64 feet to a monument box with a 1" iron pin found at an angle point therein;

Thence North 6°17'39" West continuing along said centerline of Aquilla Road a distance of 499.27 feet to a monument box with a 1" iron pin found at an angle point therein;

Thence North 10° 53' 59" East continuing along said centerline of Aquilla Road a distance of 131.82 feet to the Northwesterly corner of a 5.0425 acre parcel of land conveyed to Kenneth R. and Delores E. Ashba by deed recorded in Volume 1747, Page 2273 of Geauga County Deed Records and the Principle Place of Beginning of the premised herein intended to be described;

COURSE I Thence North 10° 53' 59" East continuing along said centerline of Aquilla Road a distance of 25.62 feet to a point;

COURSE II Thence North 88°04'20" East passing through a 5/8 inch iron pin set at 30.77 feet, a total distance of 142.54 feet to a 5/8 inch iron pin set;

COURSE III Thence South 82°03'24" East a distance of 110.42 feet to a 5/8 inch iron pin set;

LEGAL DESCRIPTION

0.1233 Acre Parcel
Kenneth R. and Delores E. Ashba
Page Two

COURSE IV Thence South 88°35'08" East a distance of 78.73 feet to a 5/8 inch iron pin set in the Northerly line of land so conveyed to Kenneth R. and Delores E. Ashba;

COURSE V Thence South 87°49'21" West along said Northerly line of land so conveyed to Kenneth R. and Delores E. Ashba, passing through a 5/8 inch iron pin found at 304.82 feet (I.D. Schwartz, 7193) a total distance of 335.62 feet to the Principle Place of Beginning and containing 0.1233 acres of land (0.1057 acres of land excluding the area within the right-of-way of Aquilla Road) as surveyed, calculated and described on December 28, 2004 by Rudy E. Schwartz, P.S. 7193 be the same more or less but subject to all legal highways and easements of record. Bearings used herein refer to an assumed meridian and are intended to indicate angles only. All 5/8 inch iron pins set are I.D. Schwartz 7193.

12.28.04

DATE

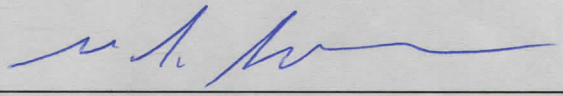

RUDY E. SCHWARTZ, P.S. 7193



SURVEY PLAT & LEGAL DESCRIPTION
APPROVED PER R.C. 315.251

PAK 12/30/04

OFFICE OF THE
GEAUGA COUNTY ENGINEER

BVR 00002

LEGAL DESCRIPTION
OF A
0.1057 ACRE PARCEL
TO BE CONVEYED TO
KENNETH R. ASHBA III AND LYNN M. ASHBA

Situated in the Township of Burton, County of Geauga and State of Ohio and known as being a part of Lot No. 32 and further being known as part of a Parcel of land conveyed to Kenneth R. and Delores E. Ashba by deed recorded in Volume 1747, Page 2273 of Geauga County Deed Records; further bounded and described as follows;

Beginning at a point in the centerline of Kinsman Road (S.R. 87), width varies, at its intersection with the centerline of Aquilla Road, 60 feet wide, as shown by Centerline Plat of Aquilla Road on file at the Geauga County Engineer's office;

Thence North 07°31'14" West along said centerline of Aquilla Road a distance of 756.52 feet to a monument box with a 1" iron pin found at an angle point therein;

Thence North 10°16'12" West continuing along said centerline of Aquilla Road a distance of 728.64 feet to a monument box with a 1" iron pin found at an angle point therein;

Thence North 6°17'39" West continuing along said centerline of Aquilla Road a distance of 499.27 feet to a monument box with a 1" iron pin found at an angle point therein;

Thence North 10° 53' 59" East continuing along said centerline of Aquilla Road a distance of 131.82 feet to the Northwesterly corner of a 5.0425 acre parcel of land conveyed to Kenneth R. and Delores E. Ashba by deed recorded in Volume 1747, Page 2273 of Geauga County Deed Records;

Thence North 87°49'21" East along the Northerly line of land so conveyed to Kenneth R. and Delores E. Ashba, passing through a 5/8 inch iron pin found at 30.80 feet (I.D. Schwartz 7193) a total distance of 335.62 feet to a 5/8 inch iron pin set and the Principal Place of Beginning of the premises herein intended to be described;

COURSE I Thence North 87°49'21" East continuing along said Northerly line of land so conveyed to Kenneth R. and Delores E. Ashba, a distance of 382.98 feet to a 5/8 inch iron pin found (I.D. Schwartz 7193) at the Northeasterly corner thereof;

COURSE II Thence South 2°10'39" East along the Easterly line of land so conveyed to Kenneth R. and Delores E. Ashba, a distance of 24.04 feet to a 5/8 inch iron pin set;

BUR 00002

LEGAL DESCRIPTION

0.1057 Acre Parcel

Kenneth R. Ashba III and Lynn M. Ashba

Page Two

COURSE III

Thence North 88°35'08" West a distance of 383.73 feet to the Principle Place of Beginning and containing 0.1057 acres of land) as surveyed, calculated and described on December 28, 2004 by Rudy E. Schwartz, P.S. 7193 be the same more or less but subject to all legal highways and easements of record. Bearings used herein refer to an assumed meridian and are intended to indicate angles only. All 5/8 inch iron pins set are I.D. Schwartz 7193.

12.28.04

DATE

RUDY E. SCHWARTZ, P.S. 7193

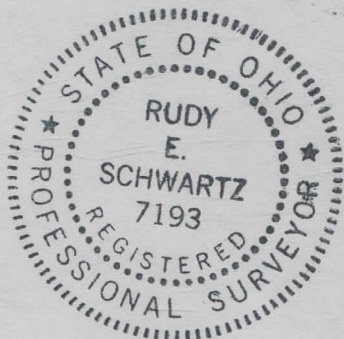

SURVEY PLAT & LEGAL DESCRIPTION
APPROVED PER R.C. 315.251

PAK 12/30/04

OFFICE OF THE
GEAUGA COUNTY ENGINEER